

Organised by:

UBMi BV

de Entree 73
Toren A
1101 BH Amsterdam
PO Box 12740
The Netherlands
Tel: +31 20 40 99 544
Fax: +31 20 36 32 616
E-mail: cphi@ubm.com
Internet: www.cphi.com

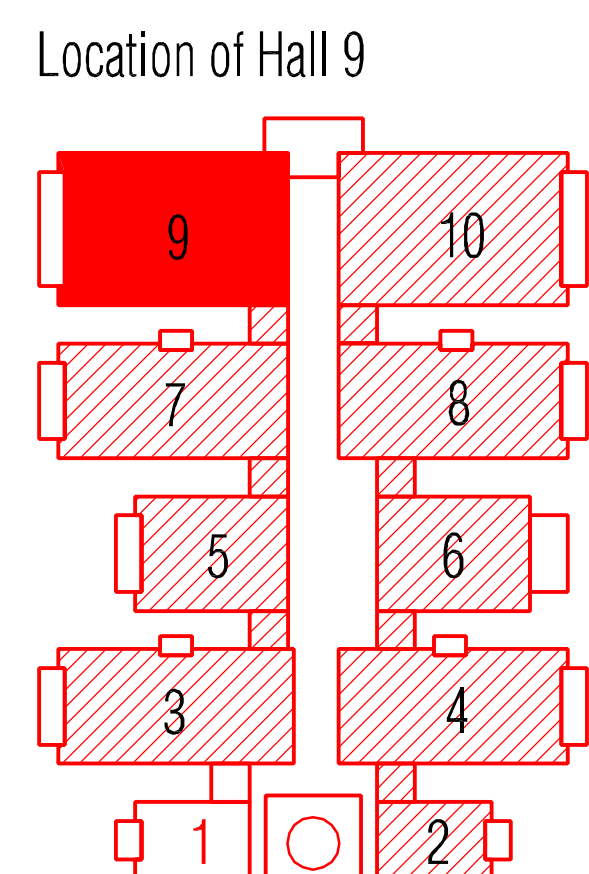

Compulsory Gangways

Version 8b, Issued 9/10/11

This plan is subject to change at the discretion of the Event Organiser.

Ceiling height in Hall - 10.80 meters
Height in Hall Link - 4.35 meters

- Pillar, 70cm diameter
- Double Pillar, 56 x 120cm overall
- Restaurant
- Food and Beverages
- Cloak Room
- Toilets
- Information Point
- Exits
- Fire Hydrants (under floor) - access at all times

APIs Zone

Excipients/Formulation Zone

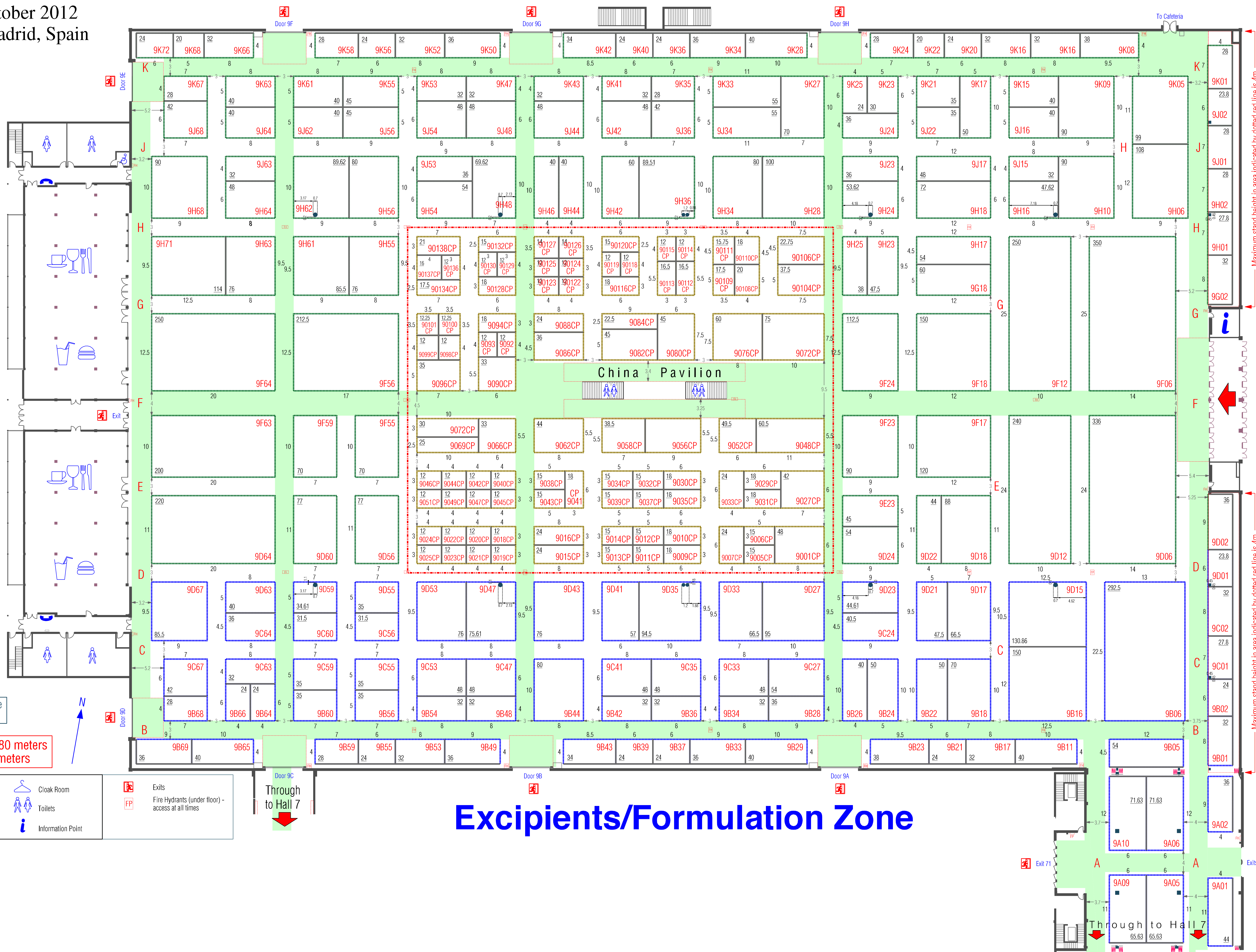

Maximum stand height in area indicated by dotted red line is 4m

Maximum stand height in area indicated by dotted red line is 4m

MAIN ENTRANCE (Hall 9)

Through to Hall 7

Through to Hall 7